

Beginning on April 16, 2023, a detour will be in place on Alta Drive between Faye Road and Port of Jacksonville Parkway to allow Jacksonville Transportation Authority (JTA) contractors to raise the elevation of the roadway in two locations.

- The first location is north of Faye Road just North of the Selina Plaza. All traffic traveling north on Alta Drive will be detoured via Faye Road to New Berlin Road.
- The second location is between Misty Marsh Drive and Marshwinds Way. All traffic traveling south on Alta Drive will be detoured via Port of Jacksonville Parkway to New Berlin Road. There will also be sewer, storm drain, and roadway improvements performed during this detour.

JTA anticipates the detour to be in place from April 16, 2023, through June 14, 2023.

As your point of contact, my role is to answer questions or concerns related to the project so please do not hesitate to contact me at (904) 619-8605, or at [cjones@adgmark.com](mailto:cjones@adgmark.com). I will do my best to address your concerns as efficiently as possible.

As your point of contact, my role is to answer questions or concerns related to the project so please do not hesitate to contact me at (904) 619-8605, or at [cjones@adgmark.com](mailto:cjones@adgmark.com). I will do my best to address your concerns as efficiently as possible.

To learn more about the Alta Drive Improvements project visit us online at [mobilityworks.jtafla.com](http://mobilityworks.jtafla.com).

Sincerely,

Cantrece Jones  
Project Communications  
Jacksonville Transportation Authority  
100 LaVilla Center Drive  
Jacksonville, FL 32204  
Office: (904) 619-8605  
[cjones@adgmark.com](mailto:cjones@adgmark.com)



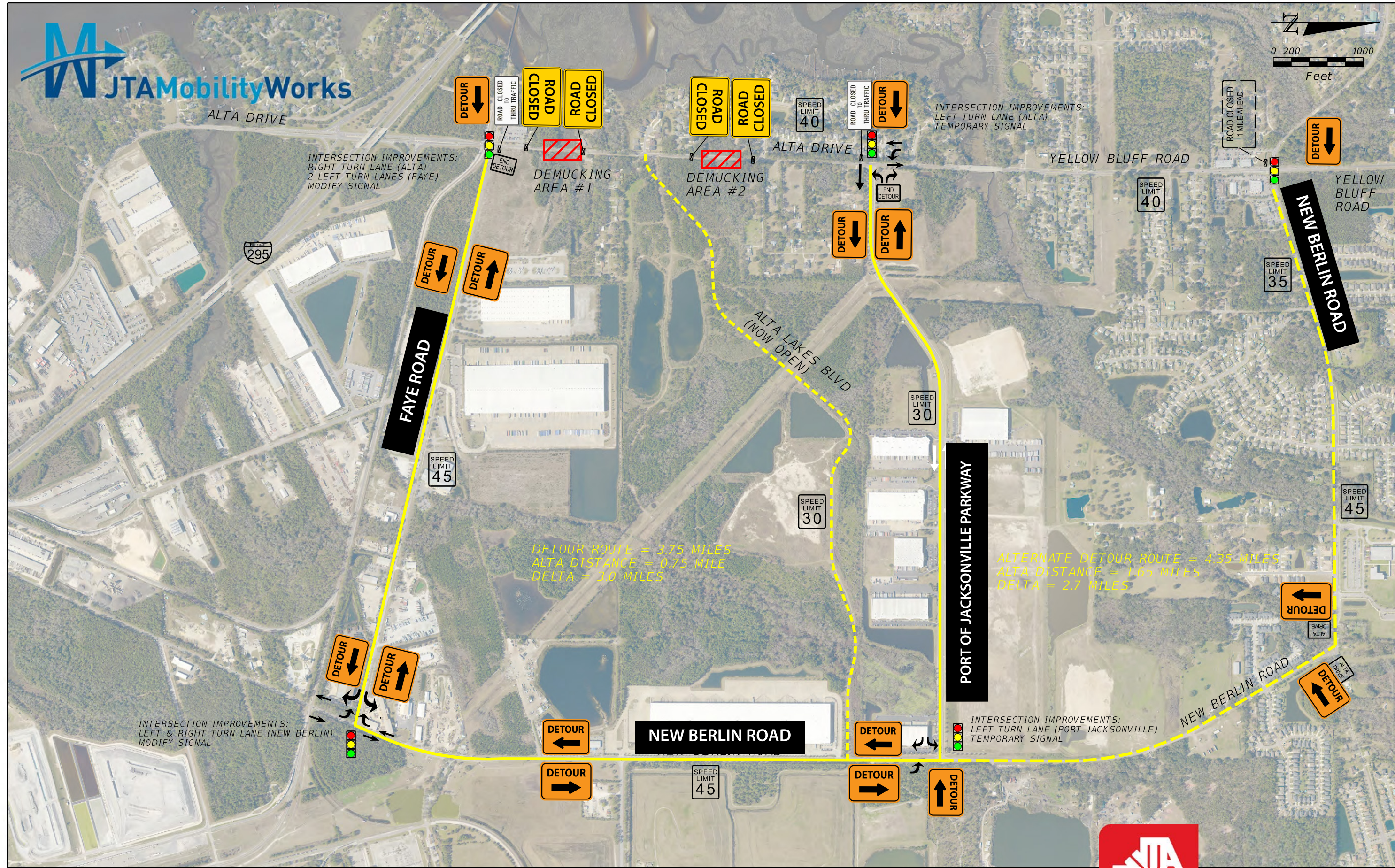

**ALTA DRIVE TEMPORARY DETOUR - BEGINNING APRIL 16, 2023**

